

DS-2CD6B35G0-PLW 3MP Wireless Macro Camera



- High quality imaging with 3 MP resolution
- Clear imaging against strong back light due to 120 dB true WDR technology
- Supports white light and 24/7 colorful imaging
- Easy installation with small lens and recommended within 0.1 m to 0.5 m of object
- Built-in microphone for real-time audio security
- Water and dust resistant (IP67)
- Realize Wi-Fi connection with coverage up to 80 m in open areas

▪ Specification

Camera	
Image Sensor	1/2.7" Progressive Scan CMOS
Max. Resolution	2048 × 1536
Min. Illumination	Color: 0.005 Lux @ (F1.2, AGC ON)
Shutter Time	1/3 s to 1/100,000 s
Lens	
Lens Type	Fixed focal lens, 4 mm
Focal Length & FOV	4 mm, horizontal FOV 74.9°, vertical FOV 59°, diagonal FOV 89.4°
Iris Type	Fixed
Focus	Auto, Manual, Semi-auto
DORI	
DORI	D: 82.2 m, O: 32.6 m, R: 16.4 m, I: 8.2 m
Illuminator	
Supplement Light Type	White Light
Supplement Light Range	Up to 0.5 m
Video	
Main Stream	50 Hz: up to 25 fps, default by 15 fps (2048 × 1536, 1920 × 1080, 1280 × 720) 60 Hz: up to 30 fps, default by 15 fps (2048 × 1536, 1920 × 1080, 1280 × 720)
Sub-Stream	50 Hz: up to 25 fps, default by 10 fps (704 × 576, 640 × 480) 60 Hz: up to 30 fps, default by 10 fps (704 × 480, 640 × 480)
Video Compression	Main stream: H.265/H.264, Sub-stream: H.265/H.264/MJPEG
H.264 Type	Baseline Profile, Main Profile, High Profile
H.265 Type	Main Profile
Bit Rate Control	CBR, VBR
Scalable Video Coding (SVC)	H.264 and H.265 encoding
Region of Interest (ROI)	1 fixed region for main stream
Video Bit Rate	32 Kbps to 8 Mbps
Audio	
Audio Type	Mono sound
Audio Compression	G.711/G.722.1/G.726/MP2L2/PCM/MP3/AAC-LC
Audio Bit Rate	64 Kbps (G.711ulaw/G.711alaw)/16 Kbps (G.722.1)/16 Kbps (G.726)/32 to 160 Kbps (MP2L2)/8 to 48 Kbps (PCM)/8 to 160 Kbps (MP3)/16 to 64 Kbps (AAC-LC)
Audio Sampling Rate	16 kHz
Environment Noise Filtering	Yes
Network	
Protocols	SNMP, DDNS, RTP, UDP, UPnP, DHCP, IGMP, NTP, IPv4, SSL/TLS, TCP/IP, RTSP, ICMP, IPv6, QoS, DNS, HTTP
Simultaneous Live View	Up to 15 channels
API	Open Network Video Interface, ISAPI, SDK, ISUP
User/Host	Up to 32 users 3 user levels: administrator, operator, and user
Network Storage	NAS (NFS, SMB/CIFS), NVR

Security	Password protection, complicated password, HTTPS encryption, 802.1X authentication (EAP-TLS, EAP-LEAP, EAP-MD5), watermark, IP address filter, basic and digest authentication for HTTP/HTTPS, WSSE and digest authentication for Open Network Video Interface, RTP/RTSP OVER HTTPS, Control Timeout Settings, Security Audit Log, TLS 1.2, TLS 1.3
Client	iVMS-4200, Hik-Connect, HCP
Web Browser	Plug-in required liveview: IE 10, IE 11, Plug-in free liveview: Chrome 57.0+, Firefox 52.0+, Edge 89+, Safari 11+, Local service: Chrome 57.0+, Firefox 52.0+, Edge 89+
Wi-Fi	
Encryption Mode	64/128-bit WEP, WPA-EAP/WPA2-EAP, WPA-PSK/WPA2-PSK, WPS, WAPI-PSK, WAPI-CERT
Wi-Fi Protocol	IEEE802.11b, IEEE802.11g, IEEE802.11n
Frequency Range	2.4 GHz to 2.4835 GHz
Channel Bandwidth	20/40 MHz
Modulation	802.11b: CCK, QPSK, BPSK, 802.11g/n: OFDM
Wireless Range	Up to 80 m (The performance varies based on actual environment)
Image	
Image Settings	saturation, brightness, contrast, sharpness, adjustable by client software or web browser
Day/Night Switch	Day, Night, Auto, Schedule
Wide Dynamic Range (WDR)	120 dB
Image Enhancement	BLC, HLC, 3D DNR, Distortion Correction
Privacy Mask	4 rectangular privacy masks
Interface	
Ethernet Interface	1 RJ45 10 M/100 M self-adaptive Ethernet port
On-Board Storage	Built-in memory card slot, support microSD/microSDHC/microSDXC card, up to 512 GB
Built-in Microphone	1 built-in microphone
Reset Key	Yes
Event	
Basic Event	Motion detection
Linkage	Upload to FTP/NAS/memory card, notify surveillance center, trigger recording
General	
Power	12 VDC \pm 25%, 0.33 A, max. 4 W, \varnothing 5.5 mm coaxial power plug
Material	Main body: Aluminum Alloy
Dimension	96.6 mm \times 106 mm \times 52 mm (3.803" \times 4.173" \times 2.047")
Package Dimension	272 mm \times 167 mm \times 98 mm (10.71" \times 6.57" \times 3.86")
Weight	Approx. 370 g (0.816 lb.)
With Package Weight	Approx. 550 g (1.21 lb.)
Storage Conditions	-30 $^{\circ}$ C to 60 $^{\circ}$ C (-22 $^{\circ}$ F to 140 $^{\circ}$ F). Humidity 95% or less (non-condensing)
Startup and Operating Conditions	-30 $^{\circ}$ C to 60 $^{\circ}$ C (-22 $^{\circ}$ F to 140 $^{\circ}$ F). Humidity 95% or less (non-condensing)

Language	33 languages: English, Russian, Estonian, Bulgarian, Hungarian, Greek, German, Italian, Czech, Slovak, French, Polish, Dutch, Portuguese, Spanish, Romanian, Danish, Swedish, Norwegian, Finnish, Croatian, Slovenian, Serbian, Turkish, Korean, Traditional Chinese, Thai, Vietnamese, Japanese, Latvian, Lithuanian, Portuguese (Brazil), Ukrainian
General Function	mirror
Approval	
EMC	CE-EMC: EN 55032:2015+A1:2020, EN 50130-4:2011+A1:2014, EN IEC 61000-3-2:2019+A1:2021, EN 61000-3-3:2013+A1:2019+A2:2021
Safety	CB: IEC 62368-1: 2014, CE-LVD: EN 62368-1:2014/A11: 2017
Environment	CE-RoHS: 2011/65/EU, WEEE: 2012/19/EU, Reach: Regulation (EC) No 1907/2006
RF	CE-RED: EN 301 489-1 V2.2.3, EN 301 489-17 V3.2.4, EN 300 328 V2.2.2, EN IEC 62311: 2020
Protection	IP67: IEC 60529-2013

▪ Typical Application

Hikvision products are classified into three levels according to their anti-corrosion performance. Refer to the following description to choose for your using environment.

This model has NO SPECIFIC PROTECTION.

Level	Description
Top-level protection	Hikvision products at this level are equipped for use in areas where professional anti-corrosion protection is a must. Typical application scenarios include coastlines, docks, chemical plants, and more.
Moderate protection	Hikvision products at this level are equipped for use in areas with moderate anti-corrosion demands. Typical application scenarios include coastal areas about 2 kilometers (1.24 miles) away from coastlines, as well as areas affected by acid rain.
No specific protection	Hikvision products at this level are equipped for use in areas where no specific anti-corrosion protection is needed.

▪ Available Model

DS-2CD6B35G0-PLW(4mm)

▪ Dimension

U-Shaped Mount

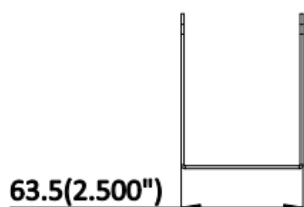
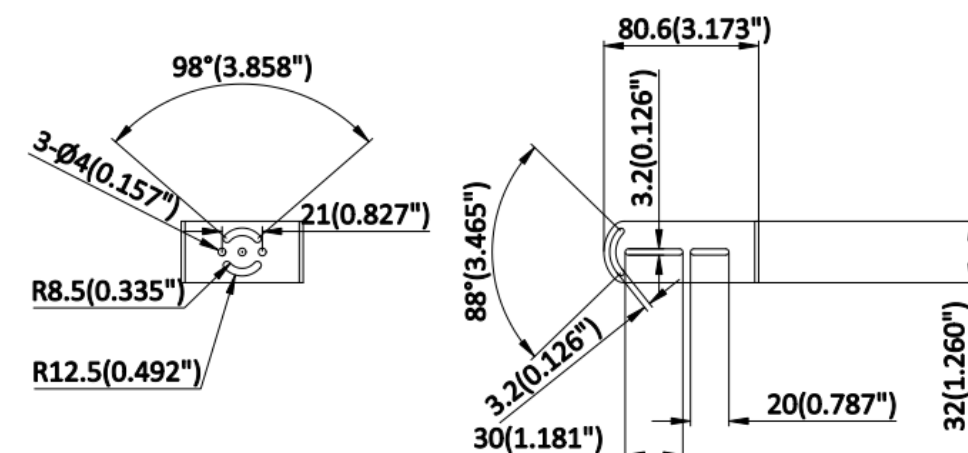

Unit:mm(inch)

Camera Mounting Hole (mm)	Camera Mounting Hole (inch)

Wall Mounting Hole (mm)	Wall Mounting Hole (inch)
$3 \times \phi 8.5$	$3 \times \phi 0.335$

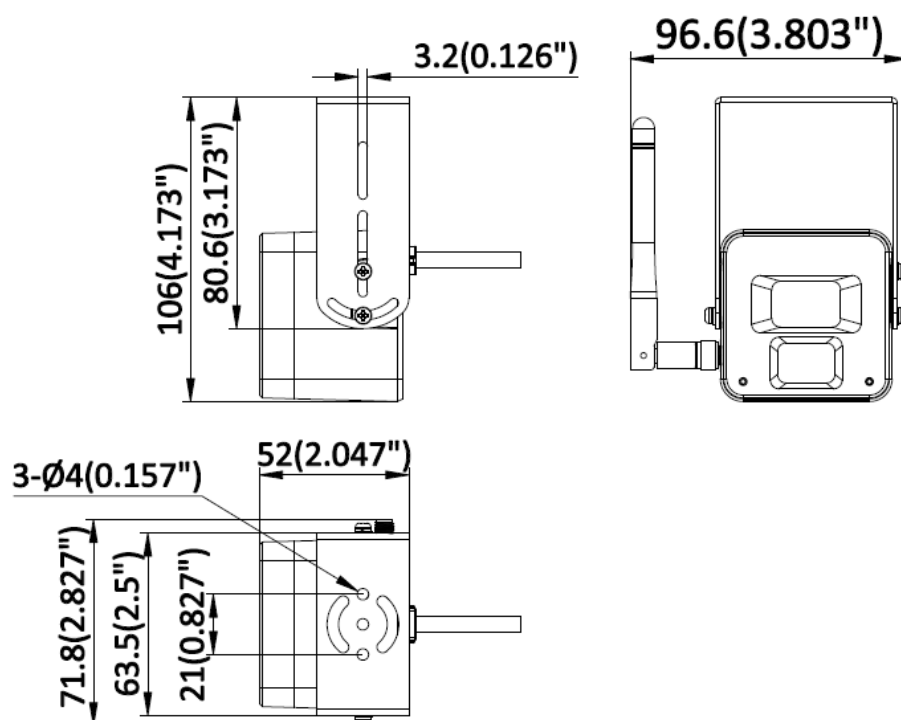

Unit:mm(inch)

Camera Mounting Hole(mm)	Camera Mounting Hole(inch)
3*φ4	3*φ4

See Far, Go Further



www.hikvision.com
support@hikvision.com

